



Enviro100EV

THE BIG SMALL BUS

The Alexander Dennis Enviro100EV is the battery-electric small bus for Transport for London routes that feels just like a big bus, engineered with the same care and attention to durability and detail as part of the next generation of Alexander Dennis zero-emission buses.

This reliable and efficient midibus meets TfL requirements for the capital's smallest single deck buses, including the latest advances of the capital's Bus Safety Standard.

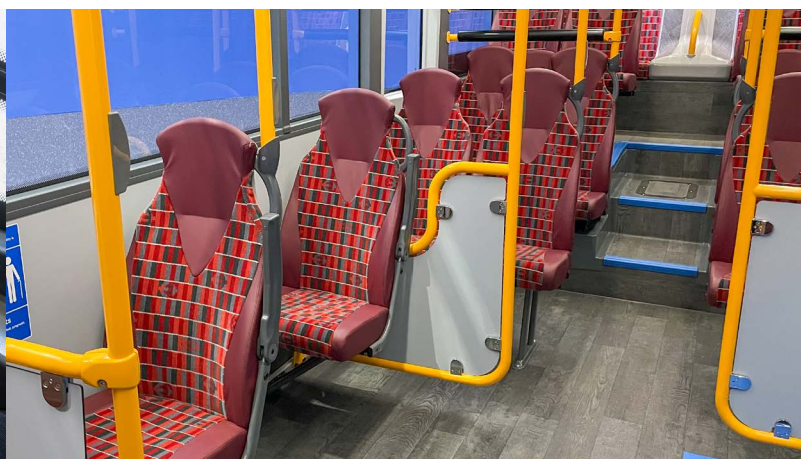

Features and benefits

- Designed and built by Alexander Dennis
- AD24 whole-vehicle aftermarket support
- Up to 5 years vehicle warranty
- Up to 1.2GWh warrantable energy throughput
- 0.54kWh/km energy efficiency in UK Bus Cycle
- 97% grid-to-wheel efficiency
- Up to 45 passengers total capacity
- TfL Bus Safety Standard compliant



Technical specifications

Construction	Welded steel chassis and stainless steel body
Dimensions	8.5m length / 4.5m wheelbase / 2.35m width / 3.1m height
Manoeuvrability	8.6m turning radius
Tyres	245/70 R17.5
Passenger capacity	Up to 45 passengers with up to 21 seats
Accessibility	1 wheelchair space accessed via electric ramp at front door
Electric motor	Voith Electrical Drive System MD, 250kW peak and 230kW continuous power
Battery system	Impact NMC lithium-ion battery, 236kWh or 354kWh
Charging system	CCS2 DC plug charging at up to 118kW (236kWh battery) or 150kW (354kWh battery) nominal power with sockets mounted on either or both sides of the vehicle, optional roof-mounted rails for pantograph charging at up to 118kW (236kWh battery) or 177kW (354kWh battery)
Operational range	573km/356mi theoretical range in UK Bus Cycle at beginning of life (354kWh battery)
Climate system	Air conditioning with zero-emission heat pump

Sample seating layout

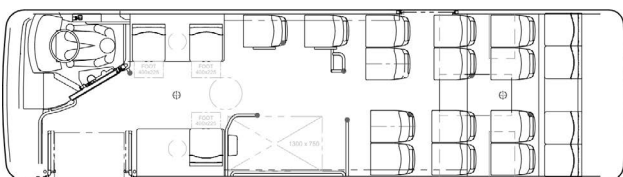

21 fixed seats + 1 wheelchair space